

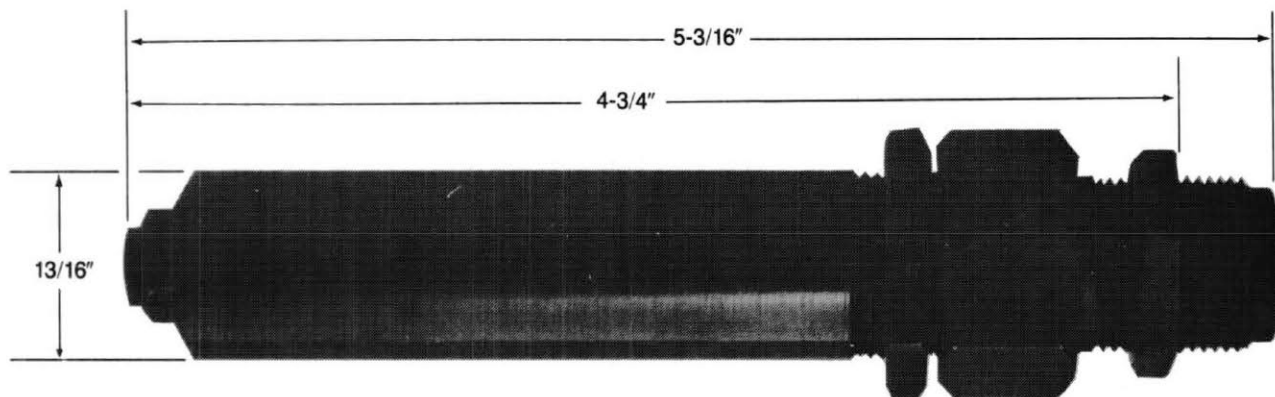

H749-8 PULLING HEAD

FOR 1/4" CHERRYMAX® RIVETS



DESCRIPTION

The H749-8 Pulling Head fits directly on the G-749 hand riveter. It will install Bulbed CherryMAX rivets in 1/4" nominal and oversize diameters, in all materials, head styles and grip lengths.

The H749-8 will also install 1/4" Wiredraw CherryMAX 'A' rivets in all materials and head styles up to a - 4 grip length.

By removing the 749A50 Adapter (parts 11, 12 & 13 on drawing), the H749-8 pulling head will fit Cherry power riveters G-744 and G-846.

USATCO U.S. Air Tool Company, Inc.

Info@usatco.com

Eastern Division60 Fleetwood Ct., Ronkonkoma, NY 11779-6907 tel: (631) 471-3300 fax: (631) 471-3308
Western Division1219 W. Mahalo Place, Rancho Dominguez, CA 90220-5446 tel: (310) 632-5400 fax: (310) 632-3900

H749-8 PULLING HEAD

FOR 1/4" CHERRYMAX® RIVETS

TECHNICAL DATA SHEET, Page 2 of 2



CHERRY®
AEROSPACE

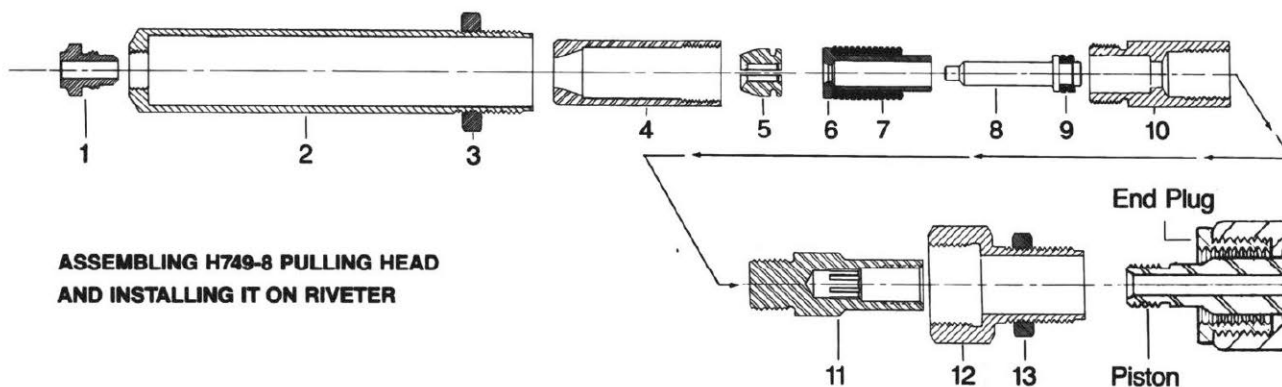

ASSEMBLING H749-8 PULLING HEAD AND INSTALLING IT ON RIVETER

1. Place jaws (5), jaw follower (6) and O-rings (7) inside collet (4). Note: If new jaws are being installed, remove O-ring which is holding jaws together.
2. Place stem stop (8) and O-rings (9) inside jaw follower (6).
3. Screw collet adapter (10) into collet (4) and tighten securely.
4. Screw drawbolt adapter (11) into collet adapter (10) and tighten securely.
5. Screw sleeve adapter (12) into end plug of riveter until it bottoms. Tighten jam nut (13) securely.
6. Screw drawbolt adapter (11), with collet assembly attached, onto end of riveter piston. Tighten se-

curely, using wrench on flats provided.

7. Screw nosepiece (1) into sleeve (2) and thread sleeve into sleeve adapter (12) until it bottoms. Tighten jam nut (3) securely.

MAINTENANCE

Make certain that the pulling head is kept clean, especially around the riveting end, as adhesives, chips, sealants, etc., will clog up the serrations of the jaws and may cause slippage of the rivet stem.

In case of damage to the pulling head, dismantle and replace with parts selected from list below.

REF.	PART NO.	DESCRIPTION	QTY. REQ.
1	749B53	Nose Piece	1
2	749B45	Sleeve	1
3	642A64	Jam Nut	1
4	749B46	Collet	1
5	P610	Jaws (3 pc.)	1 set
6	749B47	Jaw Follower	1

REF.	PART NO.	DESCRIPTION	QTY. REQ.
7	P112	O-ring (2-012 N219-7)	12
8	749B48	Stem Stop	1
9	P119	O-ring (2-009 N219-7)	2
10	749B49	Collet Adapter	1
11*	749B52	Drawbolt Adapter	1
12*	749B51	Sleeve Adapter	1
13*	671A16	Jam Nut	1

*These three parts make up a 749A50 Adapter. Without the 749A50 Adapter, this pulling head will also fit G-744 and G-846 Cherry Power Riveters.

WARRANTY

Seller warrants the goods conform to applicable specifications and drawings and will be manufactured and inspected according to generally accepted practices of companies manufacturing industrial or aerospace fasteners. In the event of any breach of the foregoing warranty, Buyer's sole remedy shall be to return defective goods (after receiving authorization from Seller) for replacement or refund of the purchase price, at the Seller's option. Seller agrees to any freight costs in connection with the return of any defective goods, but any costs relating to removal of the defective or nonconforming goods or installation of replacement goods shall be Buyer's responsibility. SELLER'S WARRANTY DOES NOT APPLY WHEN ANY PHYSICAL OR CHEMICAL CHANGE IN THE FORM OF THE PRODUCT IS MADE BY BUYER. THE FOREGOING EXPRESS WARRANTY AND REMEDY ARE EXCLUSIVE AND ARE IN LIEU OF ALL OTHER WARRANTIES AND REMEDIES; ANY IMPLIED WARRANTY AS TO QUALITY, FITNESS FOR PURPOSE, OR MERCHANTABILITY IS HEREBY SPECIFICALLY DISCLAIMED AND EXCLUDED BY SELLER. This warranty is void if seller is not notified in writing of any rejection of the goods within ninety (90) days after receipt of the goods by buyer. Seller shall not be liable under any circumstances for incidental, special or consequential damages arising in whole or in part from any breach by Seller, AND SUCH INCIDENTAL, SPECIAL, OR CONSEQUENTIAL DAMAGES ARE HEREBY EXPRESSLY EXCLUDED. Our policy is one of continuous development. Specifications shown in this document may be subject to changes introduced after publication. NOTE: The properties, strength, dimensions, installed characteristics and all other information in these materials are for guidance only to aid in the correct selection of the products described herein and is not intended or implied as part of the above warranty. All applications should be evaluated for functional stability and available samples of the described parts can be requested for installed tests, suitability and evaluations.

For more information please contact our Technical Services Department at tel. 714-850-6022

USATCO U.S. Air Tool Company, Inc.

Info@usatco.com

Eastern Division60 Fleetwood Ct., Ronkonkoma, NY 11779-6907 tel: (631) 471-3300 fax: (631) 471-3308

Western Division1219 W. Mahalo Place, Rancho Dominguez, CA 90220-5446 tel: (310) 632-5400 fax: (310) 632-3900